

LightWire FF50 / FF200



LightWire FF50 is a cost effective turn-key femtosecond fiber laser with fiber delivery of the pulses all the way to your sample. Based on a well-established MOPA scheme, LightWire FF50 model laser ensures a reliable hands free operation due to its all-in-fiber construction.

LightWire FF200 is a higher power and shorter pulse version of the sister model from still very compact and cost effective package.

SPECIFICATIONS ¹⁾

Model	LightWire FF50	LightWire FF200
Central wavelength	1064 nm	
Compressed pulse duration	< 160 fs	< 130 fs
Output power	> 40 mW	> 200 mW
Oscillator pulse repetition rate	30 ± 2 MHz	
Pulse repetition rate with pulse picker	30 kHz – 30 MHz	
Pulse energy without pulse picker	> 1 nJ	> 5 nJ
Pulse energy with pulse picker	> 0.5 nJ	> 2.5 nJ
Bandwidth (typical)	15 nm	30 nm
Optical output	0.3 m fiber with collimator	
Beam quality	M ² < 1.5	
Pulse train monitoring	photodiode output	
Dimensions (L×W×H)	228×105×75 mm	228×105×85 mm
Weight	< 2 kg	< 3 kg
Power supply (AC/DC adapter included)	100–240 V, 50–60 Hz AC	
Operating conditions	10–30 °C, humidity – not condensing	

¹⁾ Due to continuous improvement all specifications are subject to change without notice.

Compact Femtosecond Fiber Lasers

FEATURES

- ▶ Pulse duration down to 130 fs
- ▶ Up to 200 mW output power
- ▶ Fiber delivery
- ▶ Compact, rugged design
- ▶ Low maintenance

APPLICATIONS

- ▶ Ultrafast spectroscopy
- ▶ Time-domain terahertz spectroscopy

OPTIONS

- ▶ Pulse picker options
[code: FF50/200-AOM]



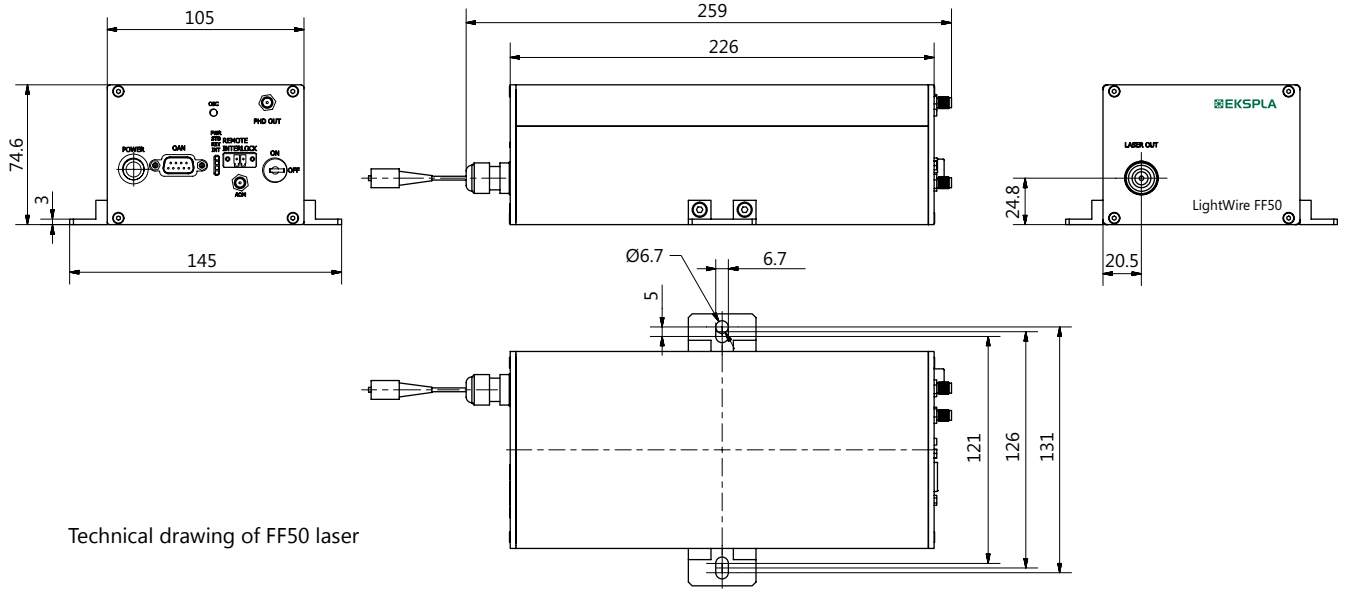

Technical drawing of FF50 laser

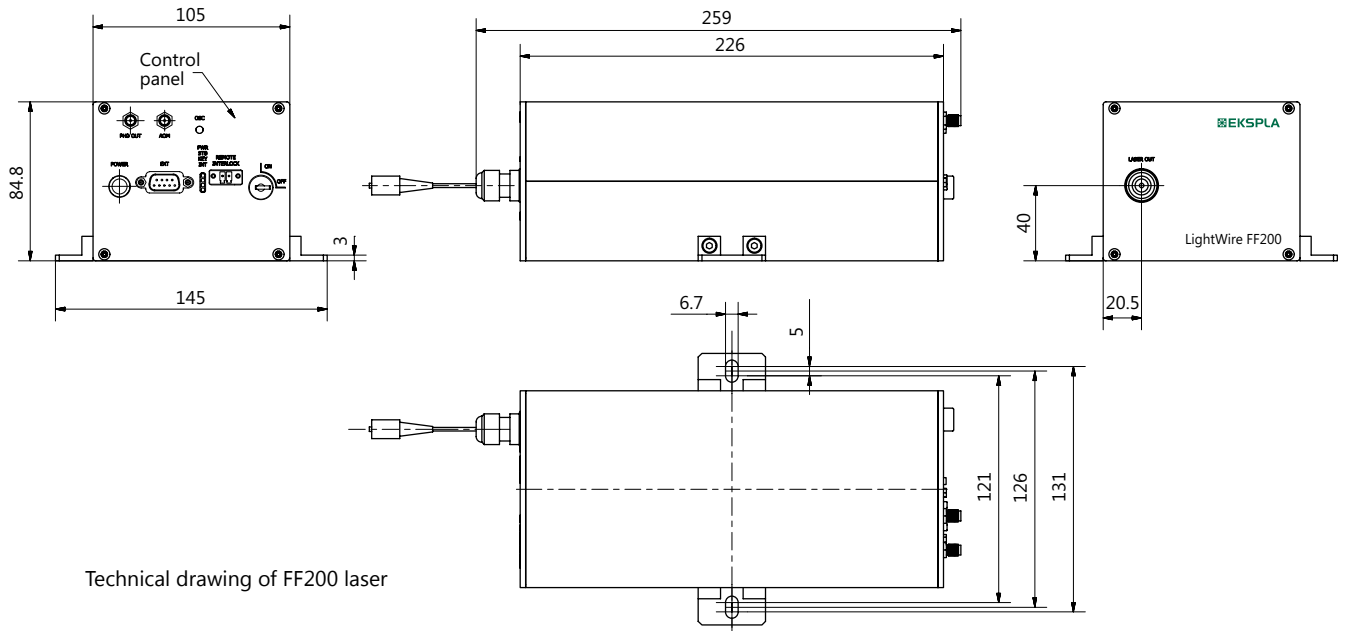

Technical drawing of FF200 laser

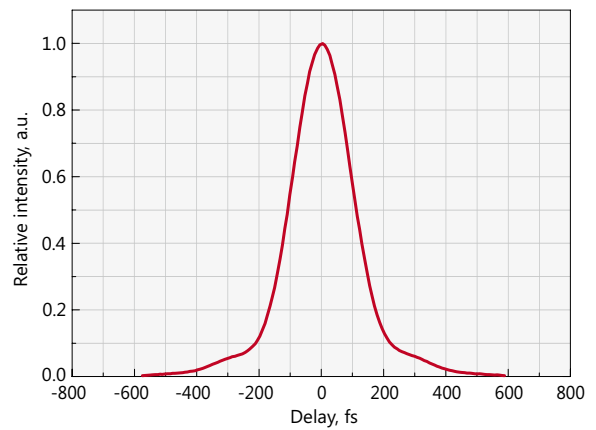
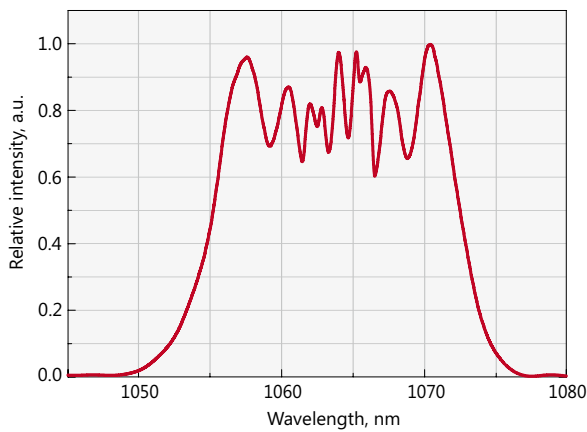

Typical spectrum (left) and autocorrelation (right) of FF50 laser