

860-0140 **PRECISION ROTARY STAGE**

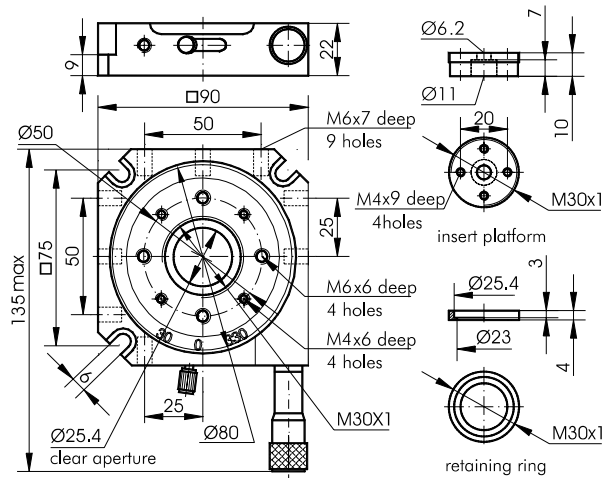

- M30×1 diameter platform insert
- Two 25 mm (1 inch) retaining rings
- Centered platform insert
- Inch & vacuum versions are available



We offer you a fine rotary stage with micrometer screw. Fine motion range is 15° with resolution of 1 arcmin. For coarse adjustment release the fixing screw and turn the platform.

The platform has M6 and M4 mounting holes. Precision rotary stage has an aperture M30×1 with clear aperture of 25 mm. Two retaining rings with 1 inch clear aperture are included.

To close the platform's aperture you can thread in an insert platform (included) with a centered clearance hole and M6, M4 holes. The stage can be fastened horizontally and vertically using M6 screws.

Code	Price, EUR
860-0140	324

SPECIFICATIONS

Rotation range	coarse 360°, resolution 1°
	fine 15°, resolution 1 arcmin
Sensitivity	20 arcsec
Reading Accuracy	1 arcmin
Wobble	1 arcmin
Load capacity	horizontal 12 kg
	vertical 5 kg
Max. drive torque	0.3 kgm
Weight	0.63 kg

860-0150 **2 INCH APERTURE ROTATION STAGE**



- Rolling ball movement
- 360° rotation
- 10° fine adjustment
- Ø 50.8 mm (2") clear aperture
- Inch version 860-0150E is available



Vertical mounting:
2 sides of the base each has two M6 holes spaced by 50 mm.

2 inch Aperture Rotation Stage 860-0150 allows full 360° coarse rotation by hand. You may lock coarse adjustment. Then fine adjustment can be done over a range of 10° using the micrometer.

Angular position is read on 360° graduated scale on the platform, which is marked every 1°. The stage has a central aperture of Ø50.8 mm. For horizontal fastening three corners of the base have clearance holes for M6 screws.

SPECIFICATIONS

Rotation range:	coarse 360°, resolution 1°
	fine 10°, resolution 1 arcmin
Sensitivity	20 arcsec
Reading accuracy	1 arcmin
Wobble	1 arcmin
Load capacity:	horizontal 15 kg
	vertical 7 kg
Weight	0.58 kg

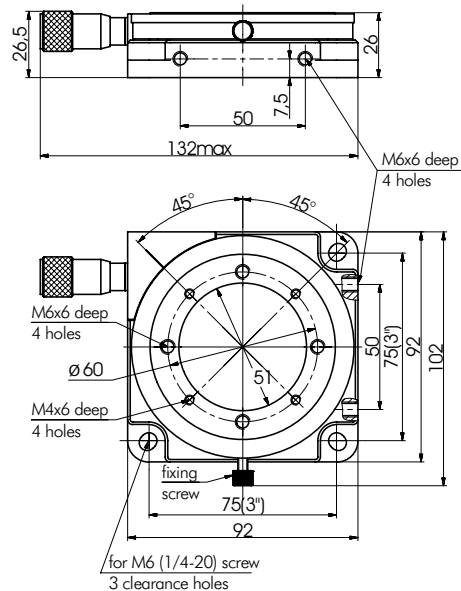

Code	Price, EUR
860-0150	317