

**LTTS-75 Series**

HOLMARC

**Travel: 50 to 250 mm**  
**Carriage Size : 75mm X 75mm**  
**Load Capacity :5kg vertical on X axis**  
**Lead Screw: 1mm pitch/9mm pitch**

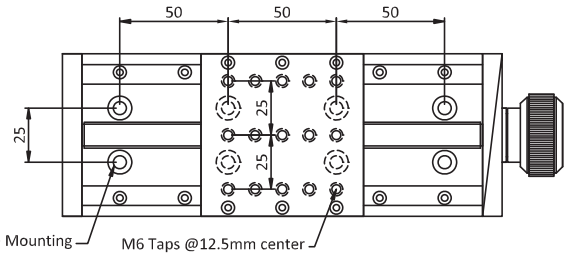

M6 CBRs for Base Mounting M6 Taps @12.5mm center



Engraved vernier scales are provided with all LTTS series translation stages.

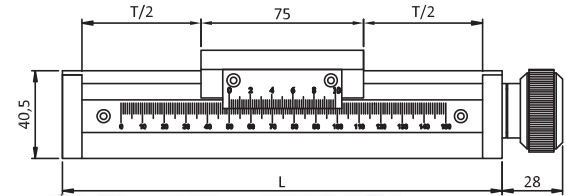
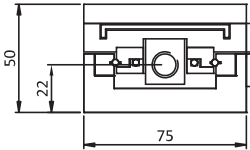

- ▶ Straight line accuracy : ±10 μm for total travel length
- ▶ Venier Readout : 0.1mm
- ▶ Guide way : Precision recirculating Guide way
- ▶ Drive : Precision lead screw
- ▶ Construction : Aluminium alloy B51S
- ▶ Finish : Black anodized
- ▶ Tapped holes on carriage : M4 tapped holes
- ▶ Mounting holes on the base : M6 tap and M4 CBR
- ▶ Design : Modular type
- ▶ Configuration : Multi axis



**Drive Details**



**1mm Pitch Lead screw**

Pitch : 1mm  
Lead screw type : Ground  
Linear resolution : 1mm/rotation  
Positioning accuracy : 10 μm  
Readout : 0.1mm precision vernier  
Feature : Fine controlled motion with 1mm pitch lead screw

**9mm Pitch Lead screw**

Pitch : 9mm  
Lead screw type : Ground  
Linear resolution : 9mm/rotation  
Positioning accuracy : 100 μm  
Readout : 0.1mm precision vernier  
Feature : Coarse movement with 9mm pitch lead screw

1mm Pitch Lead screw	Load Capacity Vertical(X Axis)	Load Capacity Vertical(Z Axis)	9mm Pitch Lead screw	Load Capacity Vertical(X Axis)	Load Capacity Vertical(Z Axis)	Travel	Length	Accessories
Model No.	Kg	Kg	Model No.	Kg	Kg	T	L	
LTTS75-50	2	1	LTTS75-50Z	2	1	50	155	Vertical Bracket Horizontal Bracket Base Plate
LTTS75-75	2	1	LTTS75-75Z	2	1	75	205	
LTTS75-100	2	1	LTTS75-100Z	2	1	100	280	
LTTS75-150	2	1	LTTS75-150Z	2	1	150	280	
LTTS75-250	2	1	LTTS75-250Z	2	1	250	280	

**Accessories**

Vertical Bracket	Horizontal Bracket	Base Plate
VAB-LTTS75-50		BP-LTTS75-50
VAB-LTTS75-100	HAB-LTTS-75	BP-LTTS75-100
VAB-LTTS75-150	Size : 75x75mm	BP-LTTS75-150
VAB-LTTS75-200		BP-LTTS75-200
VAB-LTTS75-250		BP-LTTS75-250



**◀ Angle Brackets :**

It is used to transform horizontal translators into to vertical ones. Horizontal fixed height platforms can be constructed by combining two angle brackets.

**▼ Base plates :**

Base plates can be used for mounting translation stages to breadboards and tables conveniently.

